

Thence South 03° 20' 57" West, a distance of 822.40 feet, along the line common to said 248.894 and 25.000 acre tracts, to an iron pin found marking a easterly corner common to said 248.894 acre tract and a 5.206 acre tract conveyed to W. Eugene & Florence L. Putterbaugh by a deed of record in Deed Book 402, page 249;

Thence North 86° 54' 02" West, a distance of 303.52 feet, along the line common to said 248.894 and 5.206 acre tracts, to a point;

Thence along the following forty-eight (48) courses and distances over and across said 248.894 acre tract:

1. Thence North 04° 49' 49" East, a distance of 305.86 feet, to a point;
2. Thence North 46° 04' 22" West, a distance of 119.60 feet, to a point;
3. Thence North 09° 43' 44" West, a distance of 131.54 feet, to a point;
4. Thence along a curve to the right having a radius of 280.00 feet, a central angle of 05° 32' 23", an arc length of 27.07 feet, and a chord that bears South 83° 02' 28" West, a chord distance of 27.06 feet, to a point;
5. Thence South 03° 04' 13" West, a distance of 132.24 feet, to a point;
6. Thence North 86° 55' 47" West, a distance of 560.00 feet, to a point;
7. Thence South 75° 32' 22" West, a distance of 146.82 feet, to a point;
8. Thence North 74° 03' 59" West, a distance of 125.67 feet, to a point;
9. Thence North 35° 43' 49" West, a distance of 143.50 feet, to a point;
10. Thence North 23° 25' 01" West, a distance of 418.83 feet, to a point;
11. Thence North 27° 32' 47" West, a distance of 143.50 feet, to a point;
12. Thence North 13° 25' 42" East, a distance of 143.50 feet, to a point;
13. Thence North 54° 24' 11" East, a distance of 143.50 feet, to a point;
14. Thence South 86° 46' 36" East, a distance of 128.96 feet, to a point;
15. Thence North 63° 13' 03" East, a distance of 475.14 feet, to a point;
16. Thence North 53° 20' 49" East, a distance of 143.50 feet, to a point;
17. Thence South 85° 40' 43" East, a distance of 143.50 feet, to a point;

18. Thence South $44^{\circ} 42' 14''$ East, a distance of 143.50 feet, to a point;
19. Thence South $03^{\circ} 43' 45''$ East, a distance of 143.50 feet, to a point;
20. Thence South $32^{\circ} 06' 21''$ West, a distance of 80.72 feet, to a point;
21. Thence South $03^{\circ} 04' 13''$ West, a distance of 210.00 feet, to a point;
22. Thence North $86^{\circ} 55' 47''$ West, a distance of 130.00 feet, to a point;
23. Thence South $03^{\circ} 04' 13''$ West, a distance of 30.00 feet, to a point;
24. Thence South $86^{\circ} 55' 47''$ East, a distance of 130.00 feet, to a point;
25. Thence South $03^{\circ} 04' 13''$ West, a distance of 280.00 feet, to a point;
26. Thence South $86^{\circ} 55' 47''$ East, a distance of 120.13 feet, to a point;
27. Thence South $03^{\circ} 04' 13''$ West, a distance of 130.00 feet, to a point;
28. Thence along a curve to the left having a radius of 220.00 feet, a central angle of $14^{\circ} 43' 33''$, an arc length of 56.54 feet, and a chord that bears North $85^{\circ} 42' 26''$ East, a chord distance of 56.39 feet, to a point;
29. Thence North $11^{\circ} 39' 20''$ West, a distance of 127.72 feet, to a point;
30. Thence North $81^{\circ} 16' 53''$ East, a distance of 29.36 feet, to a point;
31. Thence North $37^{\circ} 19' 10''$ East, a distance of 350.00 feet, to a point;
32. Thence North $04^{\circ} 02' 00''$ East, a distance of 256.68 feet, to a point;
33. Thence North $19^{\circ} 27' 21''$ West, a distance of 71.39 feet, to a point;
34. Thence North $09^{\circ} 05' 23''$ West, a distance of 78.57 feet, to a point;
35. Thence North $02^{\circ} 55' 54''$ East, a distance of 95.25 feet, to a point;
36. Thence North $15^{\circ} 57' 49''$ East, a distance of 93.13 feet, to a point;
37. Thence North $24^{\circ} 30' 45''$ East, a distance of 71.87 feet, to a point;
38. Thence North $67^{\circ} 41' 26''$ West, a distance of 40.17 feet, to a point;
39. Thence North $42^{\circ} 35' 08''$ West, a distance of 160.59 feet, to a point;

40. Thence North 64° 50' 59" West, a distance of 194.59 feet, to a point;
41. Thence North 68° 06' 19" West, a distance of 146.80 feet, to a point;
42. Thence North 43° 15' 32" West, a distance of 184.78 feet, to a point;
43. Thence North 87° 05' 46" West, a distance of 280.00 feet, to a point;
44. Thence South 65° 22' 30" West, a distance of 182.62 feet, to a point;
45. Thence North 85° 45' 05" West, a distance of 99.46 feet, to a point;
46. Thence North 51° 38' 31" West, a distance of 144.85 feet, to a point;
47. Thence North 10° 26' 40" West, a distance of 145.04 feet, to a point;
48. Thence North 03° 05' 20" East, a distance of 217.19 feet, to a point in the line common to said 248.894 acre tract and a 1.955 acre tract conveyed to Annabelle U. Dulin by a deed of record in Deed Book 458, page 645;

Thence South 86° 54' 40" East, a distance of 80.96 feet, along the line common to said 248.894 and 1.955 acre tracts, to an iron pin found marking a corner common to said 248.894, 1.955, and 10.157 acre tracts;

Thence South 87° 05' 46" East, a distance of 661.99 feet, along the line common to said 248.894 and 10.157 acre tracts, to an iron pin found marking a corner common to said 248.894 and 10.157 acre tracts;

Thence North 03° 32' 51" East, a distance of 794.76 feet, along the line common to said 248.894 and 10.157 acre tracts, to the POINT OF TRUE BEGINNING, containing 94.188 acres, more or less, of which 16.453 acres lie within said Farm Lot 11, 25.141 acres lie within said Farm Lot 12, 31.218 acres lie within said Farm Lot 13, and 21.376 acres lie within said Farm Lot 14, and being subject to all easements and rights-of-way of record.

The bearings used herein are based on the Grid Bearing of North 86° 28' 32" West, between Delaware County Monuments designated DEL 94 and DEL 89, as determined by a GPS network of field observations performed in July 1998.

R.D. ZANDE AND ASSOCIATES, INC.

Ch. H. Schelres, P.S. 6-21-99
Professional Surveyor No. 7385

P:\4363\Survey\Data\4363SPB1-DES.doc



DESCRIPTION OF A 57.583 ACRE TRACT OF LAND,
LOCATED SOUTH OF HOME ROAD, EAST OF SECTION LINE ROAD,
CONCORD TOWNSHIP, DELAWARE COUNTY, OHIO
(SCIOTO RESERVE RESIDENTIAL ACREAGE - SECTION 2)

Situate in the State of Ohio, County of Delaware, Township of Concord, lying partly in Farm Lots 4, Section 1, Township 3 North, Range 20 West, and partly in Farm Lots 12, 13 and 14, Section 2, Township 3 North, Range 19 West, United States Military Lands, and being a 57.583 acre tract of land out of a 248.894 acre tract conveyed to Triangle Properties, Inc. by deeds of record in Deed Book 663, Page 431, 436, 441, 446, 451 and 456, all records herein at the Recorder's Office, Delaware County, Ohio, and said 57.583 acre tract being bounded and more particularly described as follows:

BEGIN FOR REFERENCE, at a railroad spike found marking the intersection of the centerlines of Home Road (County Road 124, 60 feet-wide) and Section Line Road (County Road 5, 60 feet-wide), said railroad spike also marking the corner common to Farm Lots 14 and 15, Section 2, Township 3 North, Range 19 West, and Farm Lots 3 and 4, Section 1, Township 3 North, Range 20 West;

Thence South $86^{\circ} 49' 49''$ East, a distance of 53.27 feet, along the centerline of said Home Road, to a railroad spike found marking a north corner common to said 248.894 acre tract and a 0.299 acre parcel conveyed to Northern Telephone Company by a deed of record in Deed Book 279, page 369, said spike also marking the POINT OF TRUE BEGINNING of the 57.583 acre tract described herein;

Thence South $86^{\circ} 49' 49''$ East, a distance of 1768.47 feet, continuing along the centerline of said Home Road, to a railroad spike found marking a north corner common to said 248.894 acre tract and a 10.245 acre parcel conveyed to Larry J. Swenson, by a deed of record in Deed Book 480, page 338;

Thence South $02^{\circ} 26' 04''$ West, a distance of 741.48 feet, along the line common to said 248.894 and 10.245 acre tracts, to a point;

Thence along the following forty-nine (49) courses and distance over and across said 248.894 acre tract:

1. Thence North $87^{\circ} 05' 08''$ West, a distance of 167.87 feet, to a point;
2. Thence South $02^{\circ} 54' 52''$ West, a distance of 50.47 feet, to a point;
3. Thence along a curve to the left having a radius of 470.00 feet, a central angle of $1^{\circ} 15' 50''$, an arc length of 10.37 feet, and a chord that bears South $02^{\circ} 16' 57''$ West, a chord distance of 10.37 feet, to a point;
4. Thence South $87^{\circ} 05' 08''$ East, a distance of 129.89 feet, to a point;
5. Thence South $08^{\circ} 56' 15''$ East, a distance of 118.83 feet, to a point;

6. Thence South $27^{\circ} 50' 26''$ East, a distance of 128.01 feet, to a point;
7. Thence South $31^{\circ} 22' 50''$ East, a distance of 210.00 feet, to a point;
8. Thence South $24^{\circ} 39' 40''$ East, a distance of 94.10 feet, to a point;
9. Thence South $12^{\circ} 52' 00''$ East, a distance of 208.57 feet, to a point;
10. Thence South $58^{\circ} 56' 54''$ East, a distance of 75.13 feet, to a point;
11. Thence South $80^{\circ} 46' 52''$ East, a distance of 82.91 feet, to a point;
12. Thence South $64^{\circ} 36' 59''$ East, a distance of 112.54 feet, to a point;
13. Thence South $26^{\circ} 39' 40''$ East, a distance of 153.75 feet, to a point;
14. Thence South $18^{\circ} 56' 29''$ West, a distance of 164.00 feet, to a point;
15. Thence South $66^{\circ} 05' 52''$ West, a distance of 164.00 feet, to a point;
16. Thence North $71^{\circ} 54' 43''$ West, a distance of 129.50 feet, to a point;
17. Thence North $43^{\circ} 06' 56''$ West, a distance of 146.66 feet, to a point;
18. Thence North $57^{\circ} 36' 14''$ West, a distance of 90.78 feet, to a point;
19. Thence South $62^{\circ} 40' 42''$ West, a distance of 240.90 feet, to a point;
20. Thence South $72^{\circ} 37' 41''$ West, a distance of 79.60 feet, to a point;
21. Thence South $76^{\circ} 04' 50''$ West, a distance of 79.40 feet, to a point;
22. Thence South $81^{\circ} 41' 57''$ West, a distance of 79.40 feet, to a point;
23. Thence South $87^{\circ} 19' 03''$ West, a distance of 79.40 feet, to a point;
24. Thence North $87^{\circ} 03' 51''$ West, a distance of 79.40 feet, to a point;
25. Thence North $81^{\circ} 26' 45''$ West, a distance of 79.40 feet, to a point;
26. Thence North $75^{\circ} 49' 39''$ West, a distance of 79.40 feet, to a point;
27. Thence North $70^{\circ} 12' 33''$ West, a distance of 79.40 feet, to a point;
28. Thence North $64^{\circ} 35' 26''$ West, a distance of 79.40 feet, to a point;
29. Thence North $58^{\circ} 56' 09''$ West, a distance of 80.43 feet, to a point;

30. Thence North $53^{\circ} 14' 40''$ West, a distance of 80.43 feet, to a point;
31. Thence North $47^{\circ} 33' 12''$ West, a distance of 80.43 feet, to a point;
32. Thence North $41^{\circ} 51' 43''$ West, a distance of 80.43 feet, to a point;
33. Thence North $36^{\circ} 10' 15''$ West, a distance of 80.43 feet, to a point;
34. Thence North $31^{\circ} 08' 39''$ West, a distance of 75.59 feet, to a point;
35. Thence North $30^{\circ} 16' 25''$ West, a distance of 579.17 feet, to a point;
36. Thence North $16^{\circ} 53' 10''$ West, a distance of 126.80 feet, to a point;
37. Thence North $50^{\circ} 46' 45''$ West, a distance of 74.91 feet, to a point;
38. Thence North $89^{\circ} 35' 27''$ West, a distance of 73.58 feet, to a point;
39. Thence North $62^{\circ} 50' 23''$ West, a distance of 115.84 feet, to a point;
40. Thence North $25^{\circ} 56' 26''$ West, a distance of 242.06 feet, to a point;
41. Thence North $57^{\circ} 11' 49''$ East, a distance of 242.06 feet, to a point;
42. Thence North $84^{\circ} 28' 19''$ East, a distance of 134.07 feet, to a point;
43. Thence South $62^{\circ} 53' 30''$ East, a distance of 156.32 feet, to a point;
44. Thence North $46^{\circ} 43' 50''$ East, a distance of 477.00 feet, to a point;
45. Thence South $88^{\circ} 16' 10''$ East, a distance of 56.57 feet, to a point;
46. Thence South $43^{\circ} 16' 10''$ East, a distance of 89.70 feet, to a point;
47. Thence along a curve to the left having a radius of 320.00 feet, a central angle of $38^{\circ} 03' 21''$, an arc length of 212.54 feet, and a chord that bears North $25^{\circ} 14' 15''$ East, a chord distance of 208.66 feet, to a point of compound curvature;
48. Thence along a curve to the left having a radius of 35.00 feet, a central angle of $93^{\circ} 02' 24''$, an arc length of 56.83 feet, and a chord that bears North $40^{\circ} 18' 37''$ West, a chord distance of 50.79 feet, to a point of tangency;
49. Thence North $86^{\circ} 49' 49''$ West, a distance of 872.56 feet, along a proposed south right-of-way line over and across said 248.894 acre tract, parallel to and 50.00 feet southerly of, as measured at right angles, the centerline of said Home Road, to a point in the east line of said 0.229 acre tract;

Thence North 02° 02' 12" East, a distance of 50.01 feet, along the line common to said 248.894 and 0.229 acre tracts, passing an iron pin found at 19.99 feet in the existing south right-of-way line of said Home Road, to the Point of True Beginning, containing 64.417 acres, more or less, of which 0.041 acres lie within said Farm Lot 4, 9.587 acres lie within said Farm Lot 12, 33.941 acre lie within said Farm Lot 13, and 20.848 acres lie within said Farm Lot 14, and being subject to all easements and rights-of-way of record, and excepting therefrom the following two (2) tracts of land:

EXCEPTION 1:

Situate in the State of Ohio, County of Delaware, Township of Concord, lying in Farm Lots 13 and 14, Section 2, Township 3 North, Range 19 West, United States Military Lands, and being a 6.772 acre tract of land out of said 248.894 acre tract conveyed to Triangle Properties, Inc. by deeds of record in Deed Book 663, Pages 431, 436, 441, 446, 451 and 456, and said 6.772 acre tract being bounded and more particularly described as follows:

BEGIN FOR REFERENCE, at a railroad spike found marking the intersection of the centerlines of Home Road (County Road 124, 60 feet-wide) and Section Line Road (County Road 5, 60 feet-wide), said railroad spike also marking the corner common to Farm Lots 14 and 15, Section 2, Township 3 North, Range 19 West, and Farm Lots 3 and 4, Section 1, Township 3 North, Range 20 West;

Thence South 86° 49' 49" East, a distance of 1481.35 feet, along the centerline of said Home Road, to a point;

Thence South 03° 10' 11" West, a distance of 50.00 feet, leaving the centerline of said Home Road, to a point in the proposed south right-of-way line of said Home Road, said point marking the **POINT OF TRUE BEGINNING** of the 6.772 acre tract described herein;

Thence along the following nineteen (19) courses and distances over and across said 248.894 acre tract:

1. Thence South 03° 10' 11" West, a distance of 132.70 feet, to a point;
2. Thence South 41° 46' 10" West, a distance of 143.50 feet, to a point;
3. Thence South 10° 23' 19" West, a distance of 108.78 feet, to a point;
4. Thence South 29° 59' 18" East, a distance of 172.50 feet, to a point;
5. Thence South 02° 54' 52" West, a distance of 210.00 feet, to a point;
6. Thence South 87° 05' 08" East, a distance of 130.00 feet, to a point;
7. Thence South 02° 54' 52" West, a distance of 20.00 feet, to a point;
8. Thence North 87° 05' 08" West, a distance of 130.00 feet, to a point;

9. Thence South $77^{\circ} 11' 27''$ West, a distance of 80.35 feet, to a point;
10. Thence North $78^{\circ} 48' 46''$ West, a distance of 117.07 feet, to a point;
11. Thence North $61^{\circ} 20' 41''$ West, a distance of 58.84 feet, to a point;
12. Thence North $46^{\circ} 00' 44''$ West, a distance of 138.05 feet, to a point;
13. Thence North $43^{\circ} 16' 10''$ West, a distance of 250.00 feet, to a point;
14. Thence North $46^{\circ} 43' 50''$ East, a distance of 150.08 feet, to a point;
15. Thence North $34^{\circ} 53' 49''$ East, a distance of 88.37 feet, to a point;
16. Thence North $58^{\circ} 35' 23''$ West, a distance of 130.00 feet, to a point;
17. Thence along a curve to the left having a radius of 380.00 feet, a central angle of $26^{\circ} 09' 13''$, an arc length of 173.46 feet, and a chord that bears North $18^{\circ} 20' 01''$ East, a chord distance of 171.95 feet, to a point of compound curvature;
18. Thence along a curve to the right having a radius of 35.00 feet, a central angle of $87^{\circ} 54' 47''$, an arc length of 53.70 feet, and a chord that bears North $49^{\circ} 12' 48''$ East, a chord distance of 48.59 feet, to a point of tangency;
19. Thence South $86^{\circ} 49' 49''$ East, a distance of 424.41 feet, along a proposed south right-of-way line of said Home Road being over and across said 248.894 acre tract, parallel to and 50.00 feet southerly of, as measured at right angles, the centerline of said Home Road, to the Point of True Beginning, containing 6.772 acres, more or less, of which 0.609 acres lie within said Farm Lot 12 and 6.163 acres lie with said Farm Lot 13.

EXCEPTION 2:

Situate in the State of Ohio, County of Delaware, Township of Concord, lying in Farm Lots 14, Section 2, Township 3 North, Range 19 West, United States Military Lands, and being a 0.062 acre tract of land as an existing cemetery (Carson) reserved out of a 303 acre tract conveyed in Deed Book 51, page 505, and recorded in Cemetery Book, page 88, and said 0.62 acre tract being bounded and more particularly described as follows:

BEGIN FOR REFERENCE, at a railroad spike found at the intersection of the centerlines of Home Road (County Road 124, 60 feet in width) and Section Line Road (County Road 5, 60 feet in width), said railroad spike also marking the corner common to Farm Lots 15 and 14, Section 2, Township 3 North, Range 19 West, and Farm Lots 3 and 4, Section 1, Township 3 North, Range 20 West;

Thence South $03^{\circ} 13' 16''$ West, a distance of 695.97 feet, along the line common to said Farm Lots 4 and 14, to a point marking the westerly corner common to said Farm Lots 13 and 14;

Thence South 86° 46' 44" East, a distance of 5.17 feet, along the line common to said Farm Lots 13 and 14, to a point;

Thence North 03° 13' 16" East, a distance of 0.97 feet, to the POINT OF TRUE BEGINNING of the 0.062 acre tract described herein;

Thence along the following four (4) courses and distances around the perimeter stone wall of said 0.062 acre Carson Cemetery:

1. Thence North 01° 52' 17" East, a distance of 41.50 feet, to a point;
2. Thence North 88° 34' 19" East, a distance of 64.67 feet, to a point;
3. Thence South 02° 52' 57" West, a distance of 43.02 feet, to a point;
4. Thence South 89° 53' 05" West, a distance of 63.84 feet, to the Point of True Beginning, containing 0.062 acre, more or less;

leaving 57.583 acres, more or less, of which 0.041 acres lie within said Farm Lot 4, 9.587 acres lie within said Farm Lot 12, 33.332 acres lie within said Farm Lot 13, and 14.623 acre lie within said Farm Lot 14, and being subject to all easements and rights-of-way of record.

The bearings used herein are based on the Grid Bearing of North 86° 28' 32" West, between Delaware County Monuments designated DEL 94 and DEL 89, as determined by a GPS network of field observations performed in July 1998.

R.D. ZANDE AND ASSOCIATES, INC.

Chris Y. Scheeres, P.S. 14 June '99
Professional Surveyor No. 7385

P:\4363\Survey\Data\4363SPB3-57DES.doc

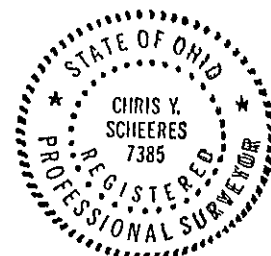

VOL 0672 PAGE 269

EXHIBIT A

DESCRIPTION OF A 86.523 ACRE TRACT OF LAND
LOCATED NORTH OF HOME ROAD, EAST OF SECTION LINE ROAD,
CONCORD TOWNSHIP, DELAWARE COUNTY, OHIO
(SCIOTO RESERVE RESIDENTIAL ACREAGE - SECTION 3)

Situate in the State of Ohio, County of Delaware, Township of Concord, lying partly in Farm Lots 15, 16, 17, 31 and 32, Section 2, Township 3 North, Range 19 West, United States Military Lands, and being an 86.523 acre tract of land comprised of 51.242 acres out of the 81.658 and 35.281 acres out of the 121.670 acre tracts conveyed to Triangle Real Estate Services, Inc. by deed of record in Deed Book 633, Pages 653, 656, 659 and Deed Book 663, Page 648, respectively, all records herein of the Recorder's Office, Delaware County, Ohio, and said 86.523 acre tract being bounded and more particularly described as follows:

Beginning at a railroad spike found marking the intersection of the centerlines of Home Road (County Road 124, 60 feet-wide) and Section Line Road (County Road 5, 60 feet-wide), said railroad spike marking the corner common to said Farm Lots 14 and 15, Section 2, Township 3 North, Range 19 West, and Farm Lots 3 and 4, Section 1, Township 3 North, Range 20 West, and said spike also marking the southwesterly corner of said 86.523 acre tract described herein;

Thence North 03°13'16" East, a distance of 707.96 feet, with the centerline of said Section Line Road, a line common to said Farm Lots 3, 15, and then 16, to a railroad spike found marking a corner common to said 121.670 acre tract and a 0.87 acre tract conveyed to Jack L. and Emmalee W. Amundson by a deed of record in Deed Book 613, Page 717;

Thence along the following two (2) courses and distances with the lines common to said 121.670 and 0.87 acre tracts;

1. Thence South 86°30'45" East, a distance of 311.95 feet, to an iron pin found marking a corner common to said 121.670 and 0.87 acre tracts;
2. Thence North 03°23'17" East, a distance of 121.12 feet, to an iron pin found marking a corner common to said 121.670 and 0.87 acre tracts in the south line of an original 61.33 acre tract conveyed as Tract #1 to Thomas E., James A. and William L. Price by a deed of record in Deed Book 622, Page 239;

Thence South 86°31'03" East, a distance of 238.24 feet, with the line common to said 81.658 and 61.33 acre tracts, to an iron pin found marking a southerly corner common to said 81.658 and 61.33 acre tracts;

Thence North 03°28'33" East, a distance of 2458.30 feet, with the line common to said 81.658 and 61.33 acre tracts, and then an original 14.36 acre tract conveyed as Tract #2 to

VOL 0672 PAGE 270

Thomas E., James A. and William L. Price by a deed of record in Deed Book 622, Page 239, to an iron pin found marking the corner common to said 81.658 and 14.36 acre tracts in the southerly right-of-way line of Lake Hill Road South as shown and delineated on the record plat of "LAKE HILL ESTATES NO. 2" in Plat Book 7, Page 255;

Thence South $88^{\circ}25'19''$ East, a distance of 810.55 feet, with the line common to said 81.658 acre tract and said "LAKE HILL ESTATES NO. 2", to an iron pin found marking corner common to said 81.658 acre tract and Lot 4193 of said "LAKE HILL ESTATES NO. 2";

Thence along the following fifty-six (56) courses and distances over and across said 81.658 and 121.670 acre tracts:

1. Thence South $00^{\circ}57'26''$ East, a distance 167.58 feet, to a point;
2. Thence North $85^{\circ}56'54''$ East, a distance of 65.82 feet, to a point;
3. Thence North $72^{\circ}00'16''$ East, a distance of 113.33 feet, to a point;
4. Thence North $50^{\circ}32'52''$ East, a distance of 248.04 feet, to a point;
5. Thence North $61^{\circ}42'44''$ East, a distance of 112.73 feet, to a point;
6. Thence South $24^{\circ}40'19''$ East, a distance of 130.00 feet, to a point;
7. Thence along a curve to the right having a radius 530.00 feet, a central angle of $02^{\circ}09'45''$, an arc length of 20.00 feet, and a chord that bears North $66^{\circ}24'33''$ East, a chord distance of 20.00 feet, to a point;
8. Thence North $22^{\circ}30'34''$ West, a distance of 130.00 feet, to a point;
9. Thence North $71^{\circ}03'27''$ East, a distance of 82.12 feet, to a point;
10. Thence North $76^{\circ}27'15''$ East, a distance of 144.58 feet, to a point;
11. Thence South $13^{\circ}23'19''$ East, a distance of 130.00 feet, to a point;
12. Thence North $76^{\circ}36'41''$ East, a distance of 473.33 feet, to a point;
13. Thence South $13^{\circ}23'19''$ East, a distance of 190.00 feet, to a point;
14. Thence South $76^{\circ}36'41''$ West, a distance of 611.91 feet, to a point;

VOL 0672 PAGE 271

15. Thence North $26^{\circ}33'53''$ West, a distance of 131.12 feet, to a point;
16. Thence along a curve to the left having a radius of 470.00, a central angle of $02^{\circ}27'10''$, an arc length of 20.12 feet, and a chord that bears South $69^{\circ}40'24''$ West, a chord distance of 20.12 feet, to a point;
17. Thence South $26^{\circ}33'53''$ East, a distance of 209.99 feet, to a point;
18. Thence South $21^{\circ}38'31''$ East, a distance of 806.27 feet, to a point;
19. Thence South $53^{\circ}27'43''$ East, a distance of 92.41 feet, to a point;
20. Thence South $12^{\circ}54'09''$ East, a distance of 109.13 feet, to a point;
21. Thence South $21^{\circ}37'42''$ West, a distance of 140.00 feet, to a point;
22. Thence South $60^{\circ}34'15''$ West, a distance of 140.00 feet, to a point;
23. Thence North $80^{\circ}29'12''$ West, a distance of 140.00 feet, to a point;
24. Thence North $41^{\circ}26'11''$ West, a distance of 140.74 feet, to a point;
25. Thence North $12^{\circ}07'42''$ West, a distance of 70.98 feet, to a point;
26. Thence North $07^{\circ}01'20''$ East, a distance of 79.78 feet, to a point;
27. Thence North $21^{\circ}38'31''$ West, a distance of 761.04 feet, to a point;
28. Thence South $67^{\circ}25'40''$ West, a distance of 169.05 feet, to a point;
29. Thence South $76^{\circ}29'43''$ West, a distance of 83.24 feet, to a point;
30. Thence South $83^{\circ}43'36''$ West, a distance of 83.24 feet, to a point;
31. Thence South $85^{\circ}42'16''$ West, a distance of 65.39 feet, to a point;
32. Thence South $74^{\circ}52'08''$ West, a distance of 123.28 feet, to a point;
33. Thence South $60^{\circ}24'54''$ West, a distance of 123.28 feet, to a point;
34. Thence South $43^{\circ}54'25''$ East, a distance of 149.34 feet, to a point;

35. Thence South $28^{\circ}07'03''$ East, a distance of 207.41 feet, to a point;
36. Thence South $16^{\circ}46'50''$ East, a distance of 92.44 feet, to a point;
37. Thence South $22^{\circ}34'48''$ East, a distance of 216.35 feet, to a point;
38. Thence South $36^{\circ}23'49''$ East, a distance of 150.88 feet, to a point;
39. Thence South $06^{\circ}03'45''$ West, a distance of 258.43 feet, to a point;
40. Thence South $17^{\circ}02'49''$ West, a distance of 90.70 feet, to a point;
41. Thence South $28^{\circ}21'48''$ West, a distance of 90.70 feet, to a point;
42. Thence South $39^{\circ}40'46''$ West, a distance of 90.70 feet, to a point;
43. Thence South $50^{\circ}59'44''$ West, a distance of 90.70 feet, to a point;
44. Thence South $63^{\circ}17'45''$ West, a distance of 97.46 feet, to a point;
45. Thence South $73^{\circ}15'55''$ West, a distance of 110.78 feet, to a point;
46. Thence along a curve to the right having a radius of 630.00 feet, a central angle of $06^{\circ}12'15''$, an arc length 68.22 feet, and a chord that bears South $07^{\circ}29'06''$ East, a chord distance of 68.18 feet, to a point;
47. Thence North $85^{\circ}37'02''$ East, a distance of 130.00 feet, to a point;
48. Thence South $01^{\circ}19'11''$ East, a distance of 163.38 feet, to a point;
49. Thence South $16^{\circ}59'26''$ West, a distance of 160.39 feet, to a point;
50. Thence South $19^{\circ}20'00''$ West, a distance of 600.00 feet, to a point;
51. Thence South $11^{\circ}15'06''$ West, a distance of 123.71 feet, to a point;
52. Thence South $03^{\circ}10'11''$ West, a distance of 140.00 feet, to a point;
53. Thence North $86^{\circ}49'49''$ West, a distance of 130.00 feet, to a point;
54. Thence South $03^{\circ}10'11''$ West, a distance of 92.92 feet, to a point of curvature;

VOL 0672 PAGE 273

55. Thence along a curve to the left having a radius of 35.00 feet, a central angle of $90^{\circ}00'00''$, an arc length of 54.98 feet, and a chord that bears South $41^{\circ}49'49''$ East, a chord distance of 49.50 feet, to a point of tangency;

56. Thence South $86^{\circ}49'49''$ East, a distance of 325.26 feet, along the proposed northerly right-of-way line of Home Road, said line being parallel to, and 50.00 feet northerly of, as measured at right angles to the centerline of said Home Road, to a point in the westerly line of a 1.110 acre tract conveyed to Janice E. Williams by a deed of record in Deed Book 485, Page 800;

Thence South $04^{\circ}00'45''$ West, a distance of 50.01 feet, with the westerly line of said 1.110 acre tract a line common with the said 121.670 acre tract, to a point marking the southerly corner common to said 1.110 and 121.670 acre tracts in the centerline of said Home Road;

Thence North $86^{\circ}49'49''$ West, a distance of 1381.75 feet, with the centerline of said Home Road to the Point Of True Beginning, containing 86.523 acres, more or less, of which 9.155 acres lie within Farm Lot 17, 6.894 acres lie within Farm Lot 31, and 35.193 acres lie within Farm Lot 32 are out of the 81.658 acre tract; 16.883 acres lie within Farm Lot 15, 4.639 acres lie within Farm Lot 16 and 13.759 acres lie within Farm Lot 31 are out of the 121.670 acre tract, and being subject to all easements and rights-of-way of record.

The bearings used herein are based on the bearing of North $86^{\circ}28'32''$ West, between Delaware County G.I.S. monuments DEL94 and DEL98, as determined by a GPS network of field observations performed in July 1988.

R.D. ZANDE AND ASSOCIATES, INC.

Chris Y. Scheeres, P.S.
Registered Surveyor No. 7385



P:\4363\survey\data\4363SP5-desc

EXHIBIT A

DESCRIPTION OF A 221.136 ACRE TRACT OF LAND LOCATED NORTH OF HOME ROAD, EAST OF SECTION LINE ROAD, CONCORD TOWNSHIP, DELAWARE COUNTY, OHIO (SCIOTO RESERVE RESIDENTIAL ACREAGE - SECTION 4)

Situate in the State of Ohio, County of Delaware, Township of Concord, lying partly in Farm Lots 15, 16, 20, 28, 29, 30, and 31, Section 2, Township 3 North, Range 19 West, United States Military Lands and being a 221.136 acre tract of land comprised of 18.379 acres out of the 20.147 acre tract, 22.232 acres out of the 63.545 acre tract, 1.851 acres out of the 121.670 acre tract, 58.103 acres out of the 97.426 acre tract, 112.790 acres out of the 113.096 acre tract, and 7.773 acres out of the 81.658 acre tract conveyed to Triangle Properties, Inc. by deeds of record in Deed Book 663, Page 648, Deed Book 663, Page 646, Deed Book 663, Page 648, Deed Book 663, Page 644, Deed Book 663, Page 641, and Deed Book 663, Pages 653, 656, and 659, respectively, all records herein of the Recorder's Office, Delaware County, Ohio, and said 221.136 acre tract being bounded more particularly described as follows:

BEGIN FOR REFERENCE, at a railroad spike found marking the intersection of the centerlines of Home Road (County Road 124, 60 feet-wide) and Section Line Road (County Road 5, 60 feet-wide), said railroad spike also marking the corner common to Farm Lots 14 and 15, Section 2, Township 3 North, Range 19 West, and Farm Lots 3 and 4, Section 1, Township 3 North, Range 20 West;

Thence South $86^{\circ}49'49''$ East, a distance of 2497.66 feet, with the centerline of said Home Road, to a railroad spike set marking an angle point in said centerline;

Thence South $87^{\circ}01'53''$ East, a distance of 1064.49 feet, continuing with the centerline of said Home Road, to a railroad spike found marking a corner common to said 20.147 acre tract and a 2.06 acre tract conveyed to Russel L. and Deanna E. Godby by a deed of record in Deed Book 564, Page 699, and said railroad spike being the POINT OF TRUE BEGINNING of the 221.136 acre tract described herein;

Thence North $03^{\circ}15'14''$ East, a distance of 243.96 feet, with the line common to said 20.147 and 2.06 acre tracts, to an iron pin found marking corner common to said 2.06 and 20.147 acre tracts;

Thence South $89^{\circ}04'20''$ West, a distance of 388.38 feet, with the line common to said 20.147 and 2.06 acre tracts, to an iron pin found marking a westerly corner common to said 20.147 and 2.06 acre tracts in the easterly line of a 7.893 acre tract conveyed to Ronnie A. Dulin by a deed of record in Deed Book 49, Page 632;

Thence North $03^{\circ}18'35''$ East, a distance of 558.17 feet, with the line common to said 20.147 and 7.893 acre tracts, to a point in said line;

Thence along the following sixty-four (64) courses and distances over and across said 20.147, 63.545, 121.670, 97.426, 113.096 and the 81.658 acre tracts:

1. Thence South $89^{\circ}39'14''$ East, a distance of 784.17 feet, to a point;
2. Thence North $09^{\circ}50'12''$ West, a distance of 129.76 feet, to a point;
3. Thence North $79^{\circ}15'31''$ East, a distance of 130.33 feet, to a point;
4. Thence along a curve to the left having a radius of 1770.00 feet, a central angle of $01^{\circ}02'24''$, an arc length of 32.13 feet, and a chord that bears North $11^{\circ}15'41''$ West, a chord distance of 32.13 feet, to a point;
5. Thence South $78^{\circ}13'07''$ West, a distance of 130.00 feet, to a point;
6. Thence North $15^{\circ}10'16''$ West, a distance of 204.61 feet, to a point;
7. Thence North $17^{\circ}18'05''$ West, a distance of 140.00 feet, to a point;
8. Thence South $72^{\circ}41'55''$ West, a distance of 241.52 feet, to a point;
9. Thence South $76^{\circ}26'07''$ West, a distance of 80.43 feet, to a point;
10. Thence South $82^{\circ}03'58''$ West, a distance of 80.43 feet, to a point;
11. Thence South $87^{\circ}45'26''$ West, a distance of 80.43 feet, to a point;
12. Thence North $86^{\circ}33'05''$ West, a distance of 80.43 feet, to a point;
13. Thence North $80^{\circ}51'36''$ West, a distance of 80.43 feet, to a point;
14. Thence North $75^{\circ}10'08''$ West, a distance of 80.43 feet, to a point;
15. Thence North $68^{\circ}55'44''$ West, a distance of 95.92 feet, to a point;
16. Thence North $62^{\circ}41'20''$ West, a distance of 80.43 feet, to a point;
17. Thence North $56^{\circ}59'51''$ West, a distance of 80.43 feet, to a point;
18. Thence North $52^{\circ}04'57''$ West, a distance of 75.16 feet, to a point;
19. Thence North $72^{\circ}07'57''$ West, a distance of 74.88 feet, to a point;

20. Thence North 61°04'09" West, a distance of 95.89 feet, to a point;
21. Thence North 20°56'04" West, a distance of 153.50 feet, to a point;
22. Thence North 20°32'24" East, a distance of 136.78 feet, to a point;
23. Thence North 59°30'53" East, a distance of 136.78 feet, to a point;
24. Thence South 81°30'39" East, a distance of 136.78 feet, to a point;
25. Thence North 61°05'46" East, a distance of 212.36 feet, to a point;
26. Thence North 42°15'00" East, a distance of 153.30 feet, to a point;
27. Thence South 84°29'34" East, a distance of 89.75 feet, to a point;
28. Thence North 65°27'03" East, a distance of 351.03 feet, to a point;
29. Thence North 10°15'47" West, a distance of 188.72 feet, to a point;
30. Thence North 67°21'04" West, a distance of 294.50 feet, to a point;
31. Thence North 55°51'33" West, a distance of 143.50 feet, to a point;
32. Thence North 19°53'33" West, a distance of 109.42 feet, to a point;
33. Thence North 86°43'17" West, a distance of 60.30 feet, to a point;
34. Thence South 83°41'54" West, a distance of 184.30 feet, to a point;
35. Thence North 58°55'30" West, a distance of 143.95 feet, to a point;
36. Thence North 18°25'15" West, a distance of 143.50 feet, to a point;
37. Thence North 22°33'14" East, a distance of 143.50 feet, to a point;
38. Thence North 61°21'55" East, a distance of 130.28 feet, to a point;
39. Thence South 70°57'04" East, a distance of 83.22 feet, to a point;
40. Thence North 76°18'49" East, a distance of 855.41 feet, to a point;

41. Thence North $04^{\circ}10'26''$ East, a distance of 61.73 feet, to a point;
42. Thence South $85^{\circ}49'34''$ East, a distance of 129.95 feet, to a point;
43. Thence North $04^{\circ}00'07''$ East, a distance of 157.37 feet, to a point;
44. Thence North $85^{\circ}59'53''$ West, a distance of 130.00 feet, to a point;
45. Thence North $04^{\circ}00'07''$ East, a distance of 210.00 feet, to a point;
46. Thence North $85^{\circ}59'53''$ West, a distance of 45.86 feet, to a point;
47. Thence South $87^{\circ}16'26''$ West, a distance of 133.29 feet, to a point;
48. Thence South $79^{\circ}46'27''$ West, a distance of 92.69 feet, to a point;
49. Thence South $76^{\circ}36'41''$ West, a distance of 815.69 feet, to a point;
50. Thence North $13^{\circ}23'19''$ West, a distance of 190.00 feet, to a point;
51. Thence North $76^{\circ}36'41''$ East, a distance of 208.97 feet, to a point;
52. Thence North $13^{\circ}23'19''$ West, a distance of 149.51 feet, to a point;
53. Thence North $30^{\circ}07'47''$ West, a distance of 49.54 feet, to a point;
54. Thence North $49^{\circ}38'52''$ West, a distance of 49.41 feet, to a point;
55. Thence North $69^{\circ}00'50''$ West, a distance of 49.57 feet, to a point;
56. Thence North $86^{\circ}25'20''$ West, a distance of 266.81 feet, to a point;
57. Thence South $83^{\circ}28'27''$ West, a distance of 71.10 feet, to a point;
58. Thence North $86^{\circ}33'04''$ West, a distance of 75.00 feet, to a point;
59. Thence North $03^{\circ}34'40''$ East, a distance of 127.33 feet, to a point;
60. Thence along a curve to the left having a radius of 50.00 feet, a central angle of $28^{\circ}31'35''$, an arc length of 24.89 feet, and a chord that bears South $33^{\circ}58'21''$ West, a chord distance of 24.64 feet, to a point;

61. Thence along a curve to the right having a radius 75.000 feet, a central angle of $122^{\circ}26'37''$, an arc length 160.28 feet, and a chord that bears South $80^{\circ}55'52''$ West, a chord distance of 131.47 feet, to a point;

62. Thence North $86^{\circ}33'04''$ West, a distance of 203.08 feet, to a point;

63. Thence North $39^{\circ}53'01''$ West, a distance of 182.15 feet, to a point;

64. Thence North $03^{\circ}26'56''$ East, a distance of 135.00 feet, to a point in the line common to said 81.658 acre tract and an 86 acre tract conveyed to Lois S. Chope, Trustee, by a deed of record in Deed Book 629, Page 266;

Thence South $86^{\circ}34'23''$ East, a distance of 2267.84 feet, with the line common to said 81.658 and 86 acre tracts, then a 99 acre tract to the north conveyed to Edwin M. and Wilma F. Jackson by a deed of record in Deed Book 633, Page 744, and then said 113.096 acre tract to the south, to an iron pin found at the southeasterly corner of said 99 acre tract, said pin being a corner common with said 113.096 acre tract;

Thence North $04^{\circ}00'07''$ East, a distance of 2621.62 feet, with a line common to said 113.096 and 99 acre tracts, to an iron pin found in the east line of said 99 acre tract marking a corner common to said 113.096 acre tract and a 5.00 acre tract conveyed to David R. and Paula Monska by a deed of record in Liber 503, Page 427;

Thence South $86^{\circ}45'21''$ East, a distance of 1327.54 feet, with a line common to said 113.096 and 5.00 acre tracts, then a 5.776 acre tract to the north conveyed to Kenneth A. and Violet D. Monska by a deed of record in Deed Book 553, Pages 357 & 440, and then a 10.00 acre tract to the north conveyed to Michael and Susan M. Jackson in Liber 483, Page 342 and Liber 505, Page 677, to an iron pin found marking the the easterly corner common to said 113.096 and 10.00 acre tracts in the west line of a 9.144 acre tract conveyed to David R. and Janis C. Miller by a deed of record in Deed Book 538, Page 75, said line also being the line common to Concord and Liberty Townships;

Thence South $04^{\circ}05'42''$ West, a distance of 4423.70 feet, with the east line of said 113.096 and 97.426 acre tracts, said line also being the line common to said Concord and Liberty Townships, to a point in said line;

Thence along the following forty-seven (47) courses and distances over and across the 97.426, 113.096, 63.545 and 20.147 acre tracts:

1. Thence North $82^{\circ}08'19''$ West, a distance of 295.33 feet, to a point;

2. Thence North $39^{\circ}28'22''$ West, a distance of 143.50 feet, to a point;

3. Thence North 49°04'25" West, a distance of 404.59 feet, to a point;
4. Thence North 44°47'51" West, a distance of 143.50 feet, to a point;
5. Thence North 03°49'22" West, a distance of 143.50 feet, to a point;
6. Thence North 40°14'34" East, a distance of 164.00 feet, to a point;
7. Thence South 87°46'54" East, a distance of 51.61 feet, to a point;
8. Thence North 47°14'37" East, a distance of 140.00 feet, to a point;
9. Thence North 42°45'23" West, a distance of 530.00 feet, to a point;
10. Thence North 56°44'39" West, a distance of 92.33 feet, to a point;
11. Thence North 85°59'53" West, a distance of 254.24 feet, to a point;
12. Thence South 04°00'07" West, a distance of 210.57 feet, to a point;
13. Thence North 85°59'53" West, a distance of 130.00 feet, to a point;
14. Thence South 04°00'07" West, a distance of 20.00 feet, to a point;
15. Thence South 85°59'53" East, a distance of 130.00 feet, to a point;
16. Thence South 04°00'07" West, a distance of 140.00 feet, to a point;
17. Thence South 09°18'30" East, a distance of 187.19 feet, to a point;
18. Thence South 22°20'24" East, a distance of 217.57 feet, to a point;
19. Thence South 19°23'29" East, a distance of 80.36 feet, to a point;
20. Thence South 04°59'33" East, a distance of 160.16 feet, to a point;
21. Thence South 00°19'18" West, a distance of 79.74 feet, to a point;
22. Thence South 05°38'09" West, a distance of 79.74 feet, to a point;
23. Thence South 74°41'06" East, a distance of 444.61 feet, to a point;

24. Thence South $73^{\circ}43'00''$ East, a distance of 145.74 feet, to a point;
25. Thence South $32^{\circ}23'54''$ East, a distance of 143.50 feet, to a point;
26. Thence South $11^{\circ}40'02''$ West, a distance of 164.00 feet, to a point;
27. Thence South $57^{\circ}51'09''$ West, a distance of 157.61 feet, to a point;
28. Thence North $80^{\circ}00'01''$ West, a distance of 169.69 feet, to a point;
29. Thence South $85^{\circ}54'14''$ West, a distance of 76.94 feet, to a point;
30. Thence North $87^{\circ}45'57''$ West, a distance of 83.24 feet, to a point;
31. Thence North $80^{\circ}32'05''$ West, a distance of 83.24 feet, to a point;
32. Thence North $74^{\circ}42'46''$ West, a distance of 83.40 feet, to a point;
33. Thence North $65^{\circ}10'18''$ West, a distance of 148.41 feet, to a point;
34. Thence South $24^{\circ}49'42''$ West, a distance of 240.00 feet, to a point;
35. Thence South $19^{\circ}46'13''$ West, a distance of 55.47 feet, to a point;
36. Thence South $00^{\circ}42'02''$ East, a distance of 50.26 feet, to a point;
37. Thence South $16^{\circ}39'17''$ East, a distance of 74.00 feet, to a point;
38. Thence South $17^{\circ}18'05''$ East, a distance of 502.65 feet, to a point;
39. Thence South $14^{\circ}18'04''$ East, a distance of 73.98 feet, to a point;
40. Thence South $12^{\circ}37'05''$ East, a distance of 73.96 feet, to a point;
41. Thence South $78^{\circ}27'47''$ West, a distance of 130.00 feet, to a point;
42. Thence along a curve to the right having a radius of 1830.00 feet, a central angle of $02^{\circ}53'31''$, an arc length of 92.37 feet, and a chord which bears South $10^{\circ}05'28''$ East, a chord distance of 92.36 feet, to a point;
43. Thence North $81^{\circ}21'18''$ East, a distance of 130.00 feet, to a point;

44. Thence South 09°59'11" East, a distance of 74.09 feet, to a point;
45. Thence South 03°06'34" East, a distance of 31.55 feet, to a point;
46. Thence South 86°55'35" East, a distance of 2.61 feet, to a point;
47. Thence South 03°17'15" West, a distance of 840.53 feet, to a point in the south line of said 20.147 acre tract, said line also being the centerline of Home Road;

Thence North 87°01'53" West, a distance of 716.46 feet, with the centerline of said Home Road to the POINT OF TRUE BEGINNING, containing 221.136 acres, more or less, of which 14.040 acres lie within said Farm Lot 15 and 4.339 acres lie within said Farm Lot 16 are out of the 20.147 acre tract; 22.232 acre lie within said Farm Lot 30 are out of the 63.545 acre tract; 1.851 acres lie within said Farm Lot 31 are out of the 121.670 acre tract; 15.665 acres lie within said Farm Lot 28 and 42.438 acres lie within said Farm Lot 29 are out of the 97.426 acre tract; 79.756 acres lie within said Farm Lot 20 and 33.042 acres lie within said Farm Lot 28 are out of the 113.096 acre tract; and 7.773 acres lie within Farm Lot 31 are out of the 81.658 acre tract, and being subject to all easements and rights-of-way of record.

The bearings used herein are based on the bearing of North 86° 28' 32" West between Delaware County G.I.S. monuments DEL94 and DEL98, as determined by a GPS network of field observations performed in July 1988.

R.D. ZANDE AND ASSOCIATES, INC.

Chris Y. Scheeres, P.S. 14 Jun 99
Registered Surveyor No. 7385

P:\M363\survey\data\M363SPB8-desc
June 15, 1999



EXHIBIT B
 Site Plan
 for Golf Course,
 1163 subdivision lots and
 92 condominium units

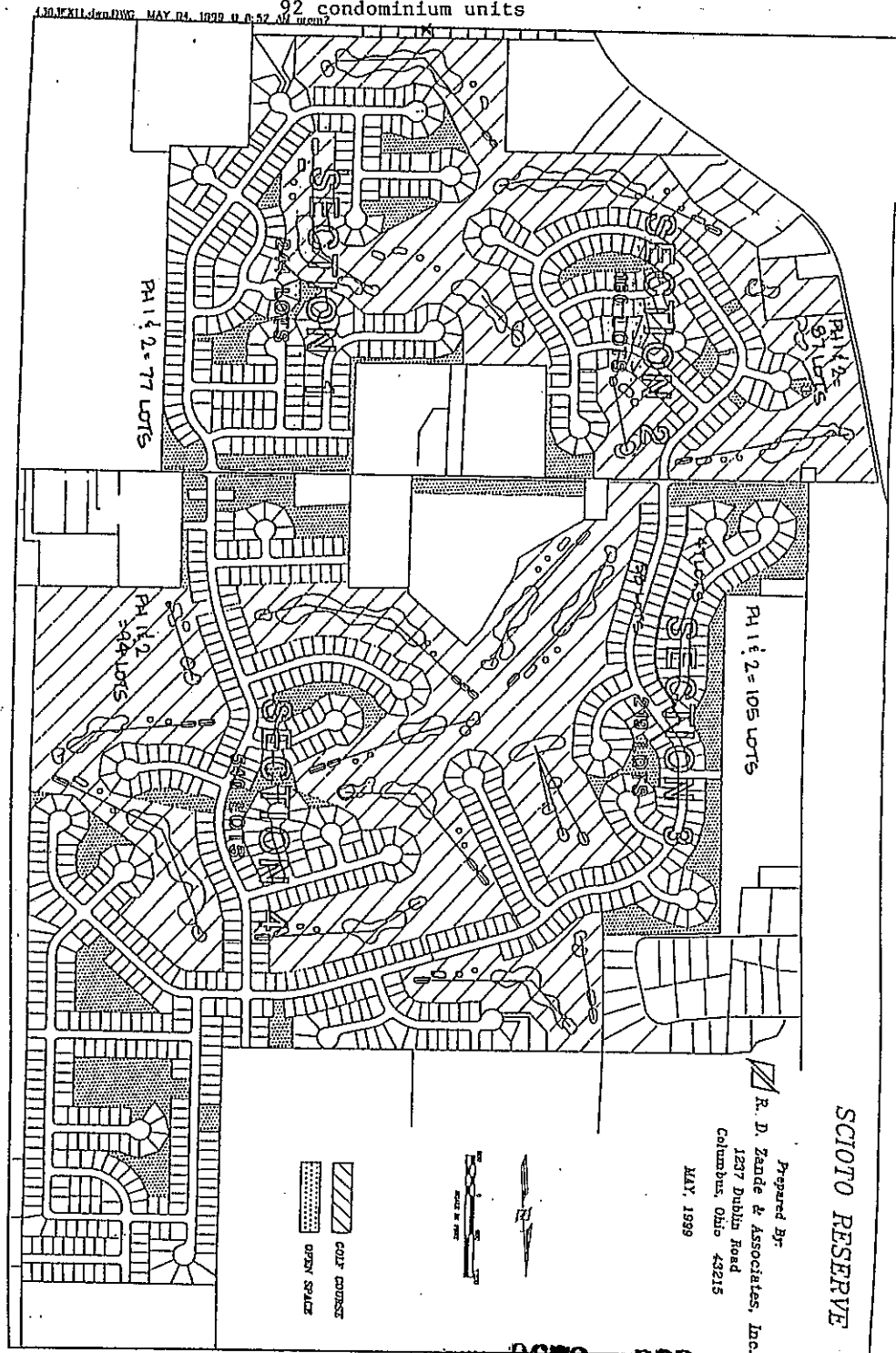

THIS PAGE INTENTIONALLY LEFT BLANK