

**CONSTRUCTION NOTES:**

- LAWN AREA, PROVIDE POSITIVE DRAINAGE ACROSS ALL SURFACES.
- LANDSCAPE AREA, PROVIDE POSITIVE DRAINAGE ACROSS ALL SURFACES.

**PLANT KEY TYPICALS**  
SEE PLANT LIST FOR SPECIFIC PLANT SPECIES

- ORNAMENTAL TREE
- EXISTING TREE
- LARGE DECIDUOUS SHRUB
- EVERGREEN SHRUB
- DECIDUOUS SHRUB
- EVERGREEN TREE
- PERENNIALS
- GROUND COVER
- SHADE TREE

**PLANT LIST ENTRY FEATURE PLANTING (COMBINED)**  
(CONTRACTOR RESPONSIBLE FOR ALL PLANTS SHOWN ON PLAN)

QTY	KEY	BOTANICAL NAME	COMMON NAME	SIZE	COND.	REMARKS
<b>TREES</b>						
23	MET	METASEQUOIA GLYPTOSTROBODES	DAWN REDWOOD	10' HGT.	B&B	
<b>SHRUBS</b>						
6	HYD	HYDRANGEA PANICULATA 'LITTLE LIME'	LITTLE LIME HYDRANGEA	24" HGT.	B&B	
20	SLP	SPIRAEA JAPONICA 'LITTLE PRINCESS'	LITTLE PRINCESS SPIREA	18" HGT.	B&B	
16	VIB	VIBURNUM X CARLICEPHALUM 'CAYUGA'	CAYUGA VIBURNUM	30" HGT.	B&B	
<b>PERENNIALS/ORNAMENTAL GRASSES</b>						
188	HEM	HEMEROCALLIS 'STELLA D'ORO'	STELLA D'ORO DAYLILY	NO. 1	CONT.	
8	NEP	NEPETA X FAASSENSII 'WALKER'S LOW'	WALKER'S LOW CATMINT	NO. 1	CONT.	

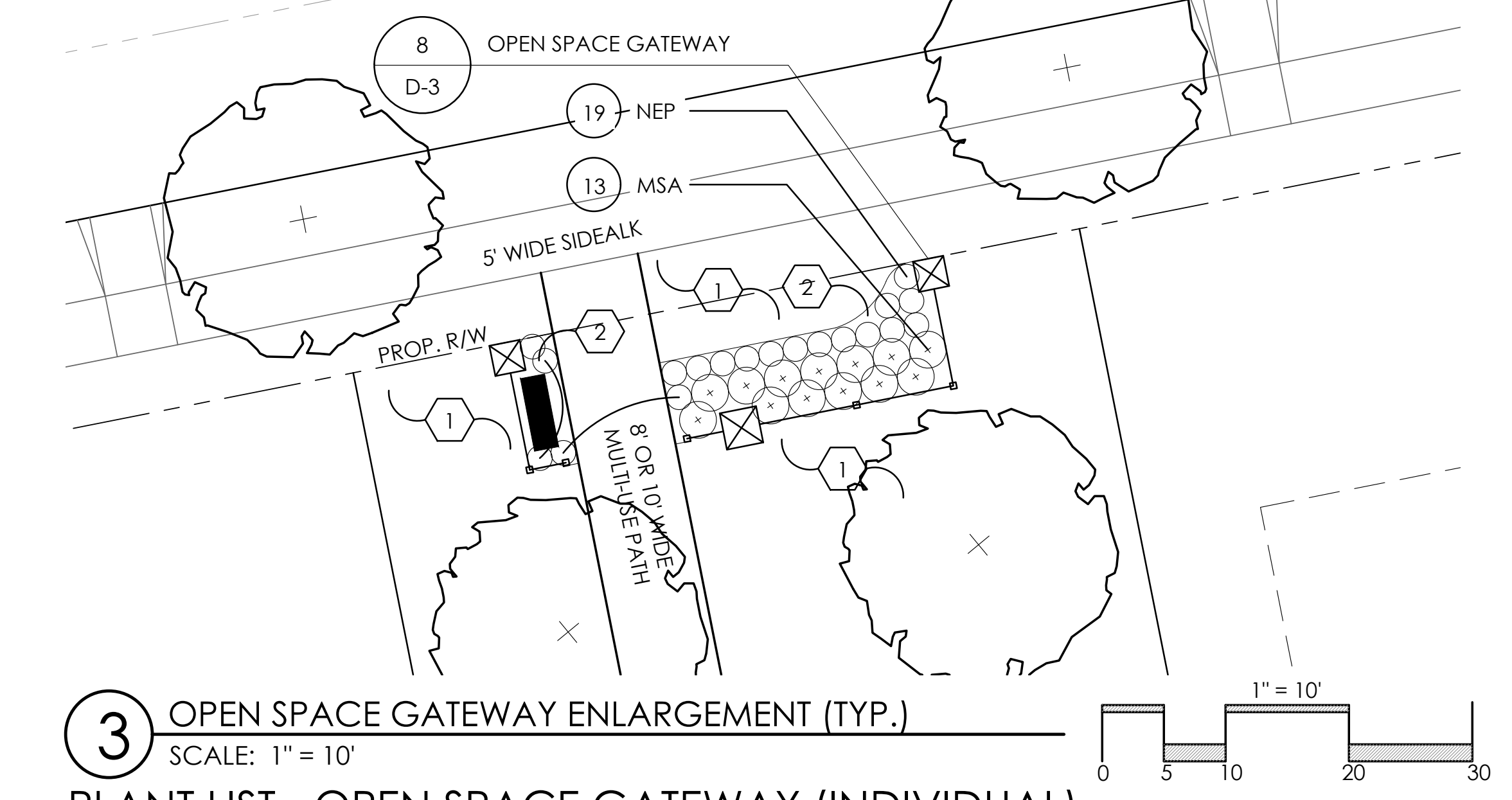

**PLANT LIST - OPEN SPACE GATEWAY (INDIVIDUAL)**  
(CONTRACTOR RESPONSIBLE FOR ALL PLANTS SHOWN ON PLAN)

QTY	KEY	BOTANICAL NAME	COMMON NAME	SIZE	COND.	REMARKS
<b>PERENNIALS/ORNAMENTAL GRASSES</b>						
13	MSA	MISCANTHUS SINENSIS 'ADAGIO'	ADAGIO MAIDEN GRASS	NO. 2	CONT.	
19	NEP	NEPETA X FAASSENSII 'WALKER'S LOW'	WALKER'S LOW CATMINT	NO. 1	CONT.	

**PLANT LIST - SINGLE FAMILY GATEWAY (INDIVIDUAL)**  
(CONTRACTOR RESPONSIBLE FOR ALL PLANTS SHOWN ON PLAN)

QTY	KEY	BOTANICAL NAME	COMMON NAME	SIZE	COND.	REMARKS
<b>TREES</b>						
10	MAG	MAGNOLIA VIRGINIANA	SWEETBAY MAGNOLIA	7-8' HGT.	B&B	
<b>SHRUBS</b>						
8	CHA	CHAMAECYPARIS PISIFERA 'LEMON THREAD'	LEMON THREAD FALSE CYPRESS	30" HGT.	B&B	
<b>PERENNIALS/ORNAMENTAL GRASSES</b>						
22	MSA	MISCANTHUS SINENSIS 'ADAGIO'	ADAGIO MAIDEN GRASS	NO. 2	CONT.	
40	NEP	NEPETA X FAASSENSII 'WALKER'S LOW'	WALKER'S LOW CATMINT	NO. 1	CONT.	

**PLANT LIST - CENTRAL PARK**  
(CONTRACTOR RESPONSIBLE FOR ALL PLANTS SHOWN ON PLAN)

QTY	KEY	BOTANICAL NAME	COMMON NAME	SIZE	COND.	REMARKS
<b>TREES</b>						
10	CVW	CRATAEGUS VIRIDIS 'WINTER KING'	WINTER KING HAWTHORN	8-10' HGT.	B&B	
44	FLO	MALUS FLORIBUNDA	JAPANESE CRABAPPLE	8-10' HGT.	B&B	
12	LIQ	LIQUIDAMBAR STYRACIFLUA 'WORPLESDON'	WORPLESDON SWEET GUM	2.5' CAL.	B&B	
20	MAG	MAGNOLIA VIRGINIANA	SWEETBAY MAGNOLIA	8-10' HGT.	B&B	
12	ULM	ULMUS 'ACCOLADE'	MORTON ELM	2.5' CAL.	B&B	
14	TIL	TILIA CORDATA 'GREENSPIRE'	GREENSPIRE LINDEN	2.5' CAL.	B&B	
22	PGL	PICEA GLAUCA	WHITE SPRUCE	5-6' HGT.	B&B	
20	PAB	PICEA ABIES	NORWAY SPRUCE	5-6' HGT.	B&B	
20	PIN	PINUS STROBUS	WHITE PINE	5-6' HGT.	B&B	

